



On-Campus Living in Steamboat Springs

WELCOME TO CMC STEAMBOAT SPRINGS!

We are excited that you're interested in on-campus living. Enclosed you'll find helpful information about life on the Steamboat Springs campus.

Please take some time to carefully review it.

Colorado Mountain College is situated in the charming, bike-friendly ski town of Steamboat Springs. The world-renowned slopes of the Steamboat Ski Resort are just a few miles from campus; Mt. Zirkel Wilderness, Rocky Mountain National Park, and the slopes of Vail, Beaver Creek, Copper Mountain, Breckenridge, Keystone, and Arapahoe Basin are within a two-hour drive of town.

When you're ready to apply for our residential housing, simply fill out the Housing & Meal Plan Application and Agreement and pay \$25 Application Fee and \$250 Housing Deposit to ensure your slot. Housing is available on a first-come, first-serve basis. You will need your Student ID Number to submit your housing application.

Please submit your Housing Application and Deposit online at:
<https://basecamp.coloradomtn.edu>

We believe that living on campus is an experience that assists students in becoming successful, both academically and socially. That's why all first-year students at Colorado Mountain College are required to live on-campus. You will have access to campus support and services while remaining within walking distance of the diverse cultural and outdoor offerings in Steamboat Springs.

Among the campus amenities we offer are: free campus parking, convenient and healthy dining plan options, an on-campus Frisbee golf course and fitness center. You will also have convenient access to free academic tutoring, an on-campus library, and other support services. The free Steamboat Springs Bus Line stops hourly at the college and goes to both ends of town, including the Steamboat Ski Resort.

The online Housing Contract outlines policies of residential campus life at CMC. These policies help to promote a healthy and academic atmosphere. The housing agreement is for the full academic year; exceptions may be considered for individuals graduating or transferring if written notification is provided at the time of signing the agreement. Please carefully review the terms, policies and regulations within the contract and read all forms in their entirety before signing.

Assignment letters with all pertinent information will be sent approximately two weeks prior to the start of each semester. An official room assignment cannot be made until the application and agreement is complete and we have received your deposit in full. We use the information you provide on the application to assist us in selecting the best roommates possible. Learn more about our room plans and meal plan options on the following pages.





Lay of the Land

Residence Halls

The view from campus includes the Steamboat Ski Resort and nearby mountains. There are 110 rooms capable of housing 220 men and women located on 3 floors. Each room has a private bathroom with shower, and wireless internet.

Resident rooms have carpet in the bedrooms, ceramic tile in entryways, and built-in wardrobes including a vanity. One bed, mattress, desk, and desk chair are provided for each resident. If available, single rooms may be requested for an additional \$1,050 per semester. Buildings have food/beverage vending, coin-free laundry facilities, study rooms, TV lounges, and a multi-purpose room for recreation. Smoking is only allowed in designated outdoor areas.

Meal Plans

A meal plan is required for all residence hall students. We offer two meal plan options: 14 or 19 meals per week. The 19-meal plan has 100 Flex dollars and the 14 meal plan has 275 Flex dollars, which can be used in the Black Diamond Cafe. The dining hall/cafe offers three meals a day Monday through Friday, and brunch and dinner Saturday and Sunday.

The current rates for room and board charges are billed each semester and are as follows. Meal plan options are subject to change.

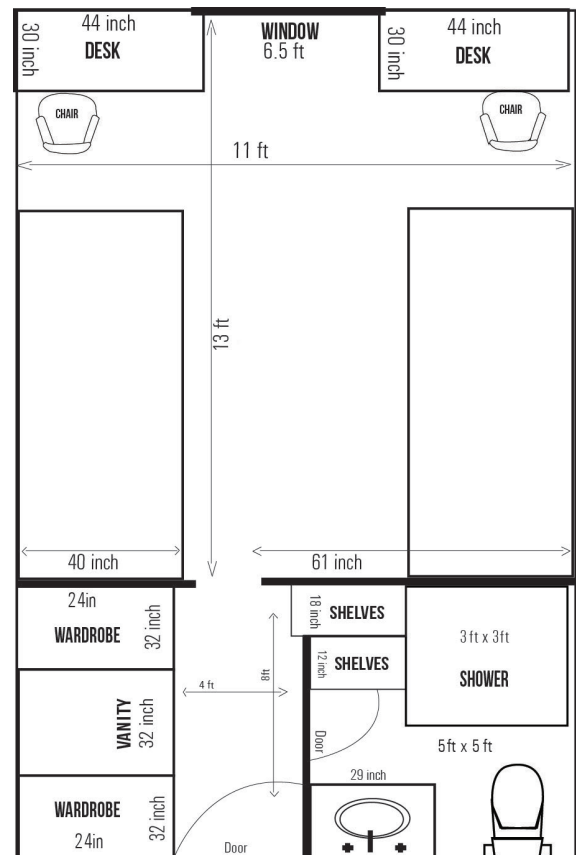

Room (Per Semester)
Double Room:
\$ 2,980.00

Meal Plans:
\$ 2,460.00

do something MAJOR



Things to Bring

Items you will need to bring:

- ✓ Alarm Clock
- ✓ Bedding: Linens, Pillow & Towels
- ✓ All beds are XL Twin Size
- ✓ Cleaning Supplies
- ✓ Laundry Detergent
- ✓ Warm Outerwear: Winter coat, Hat, Gloves & Waterproof Boots
- ✓ Desk Lamp
- ✓ Toiletries Surge Protectors with Circuit
- ✓ Breakers
- ✓ UL approved appliance (Microwave/mini-fridge)
- ✓ Adequate Lock For Bicycle (if you bring one)

Optional Items to bring:

- ✓ Personal Computer
- ✓ TV, Stereo Small Refrigerator (3.5 cu ft. or less) Small Microwave

What to leave at home:

- Open Coiled items: Hot Plates, Toaster
- Ovens, Toasters, etc.
- Incendiary items: Candles, Incense, Fuel, etc.
- Illegal drugs, any drug paraphernalia, alcohol, alcohol paraphernalia or keepsake alcohol containers.
- Bed Loft/Bunking Systems (we have loft units available to rent)
- Other restricted items noted in the Housing Contract

If you have any questions about living on campus, please feel free to contact us. We hope you choose to be a part of our Residence Hall community at Steamboat Springs!



For additional information, please contact:

Michelle Cole

Director of Student Life
mjcole@coloradomtn.edu
(970) 870-4458

April Gilliland

Assistant Coordinator of Student Life
algilliland@coloradomtn.edu
(970) 871-2013